

BUSHING NAME: LF130123-BA

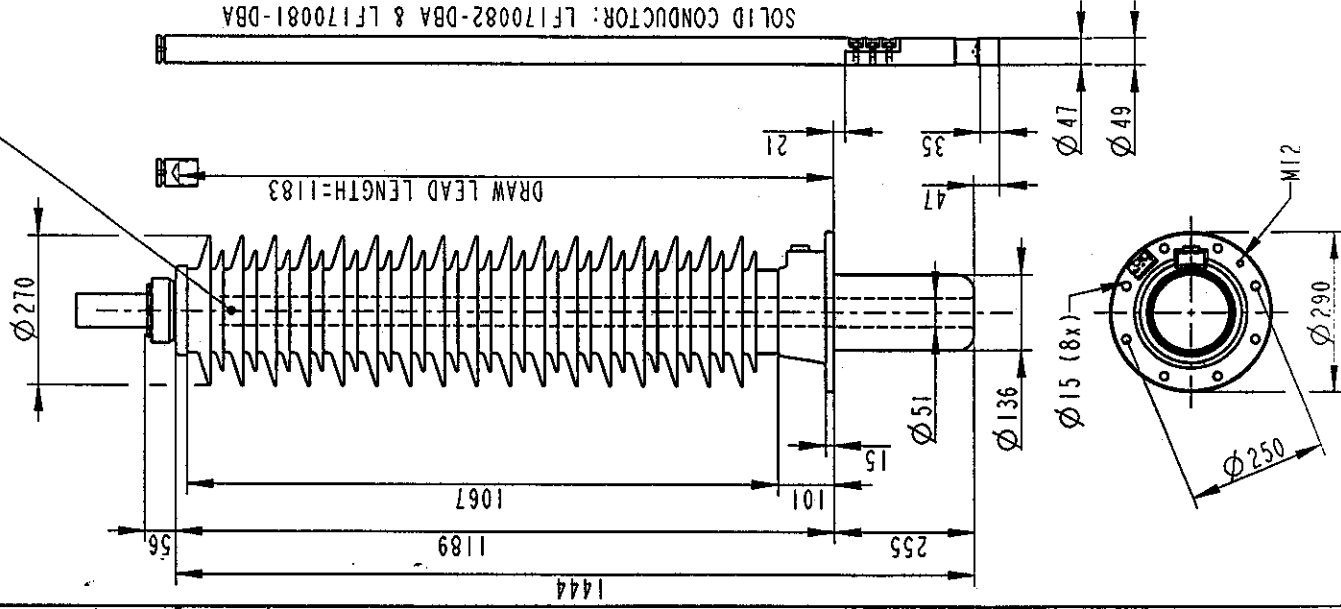

INNER TERMINAL		
Catalogue No	D. cable	MASS
LF170080-A	5	1
LF170080-B	11	1
LF170080-C	13	1
LF170080-D	15	1
LF170080-E	18	1
LF170080-F	30	1
LF170080-G	42	1
LF170080-H	45	1

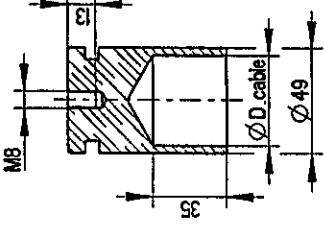

OUTER TERMINAL				
Catalogue No	MATERIAL	MASS	H2	D. STUD
LF170079-A	AL	23	125	60
LF170079-B	AL	16	125	30
LF170079-C	CU	62	125	60
LF170079-D	CU	36	125	30
LF170079-E	CU/SN	62	125	60
LF170079-F	CU/SN	36	125	30
LF170079-G	CU/AG	62	125	60
LF170079-H	CU/AG	36	125	30

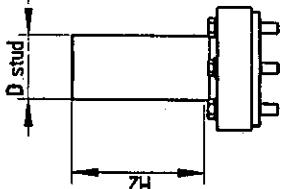

ELECTRICAL DATA, according to IEC 137

Ratings	Rated voltage	170 kV
	Max phase to earth voltage, temporary	170 kV
	Max current with Cu-conductor	1600 A
	Max current with stranded cable 740 mm ²	1000 A
	Dry lightning impulse	550 kV
	Wet power frequency	230 kV
Routine test	Dry power frequency	260 kV
Capacitance	Nominal capacitance	200 pF

GENERAL DATA, according to IEC 137

Silicone rubber insulator	Creepage distance	3913 mm
	Protected creepage distance	1700 mm
	Colour	GREY RAL 7035
Mass	Mass bushing	45 kg
Cantilever load	Cantilever test load, heavy load	4000 N
	Max cantilever operating load, bushing	2000 N
Temp class	Temperature class	CLASS 2
Mounting and service instructions		2750 55-16

ELECTRICAL DATA according to ANSI C57.19.00

Ratings	Insulation class	115 kV
	Rated max. line to ground voltage	88.4 kV
	Max current with Cu-conductor	1600 A
	Max current with stranded cable 740 mm ²	1000 A

Dim. requirements acc. to C57.19.01 not fulfilled.

ABB Components	Luxhita, Sweden
GSA123-0A/1600/0	LF130123-BA
No.	170/170
U r / AC	550 / . / 260
M	45
L	255 mm
V	0-90
Cl	pf Tan δ
C2	pf Tan δ

Based on	Responsible department	OIL-AIR BUSHING
Prepared	COM/BKU 96 44	GSA123-0A/1600/0
Approved	Date over department	
Production engineering review	ASMO	
Inspection engineering review	JOHANSSON	
Design engineering review	PETRICI	
ABB	ABB Components	2751362-DBA
Page		82
Language		1(1)

No. retains all rights in this document and in the information contained therein. Reproduction, use or disclosure in third parties without express authorisation is strictly forbidden.